

1 1/2" Ø x 18" ASTM-A36 ALL-THREAD w/ WEDGE WASHER

2 3/8" Ø x 0.19" WALL, (F_y = 65 KSI, F_u = 80 KSI) WITH (2) 3/4" Ø SAE J429 GRADE 8 THRU BOLTS

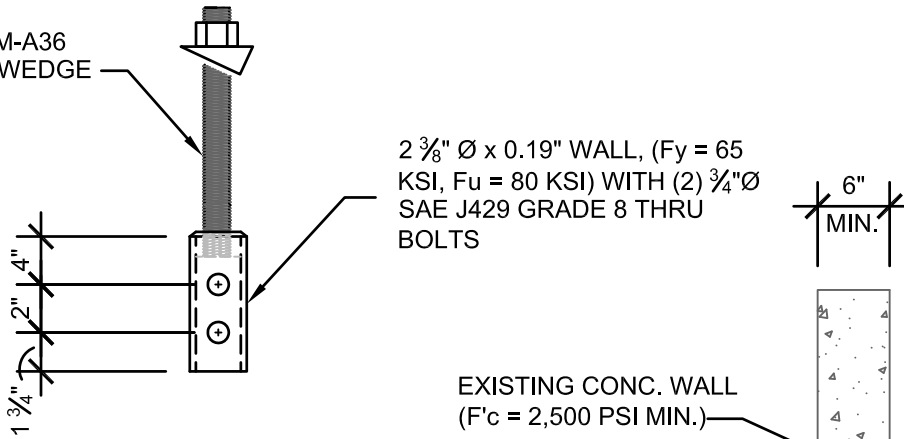

EXISTING CONC. WALL (F'_c = 2,500 PSI MIN.)

Ø2 TYPICAL 2 7/8" Ø TIEBACK CONNECTION DETAIL

MAX. 6" Ø HOLE THROUGH WALL (GROUTED)

C8x11.5 x 2'-6

PL 1/2" x 7" x 0'-7 (ASTM - A36)

2 7/8" HELICAL PILE (REF. APPROPRIATE PILE SPECIFICATIONS FOR ADD'L INFO NOT SHOWN)

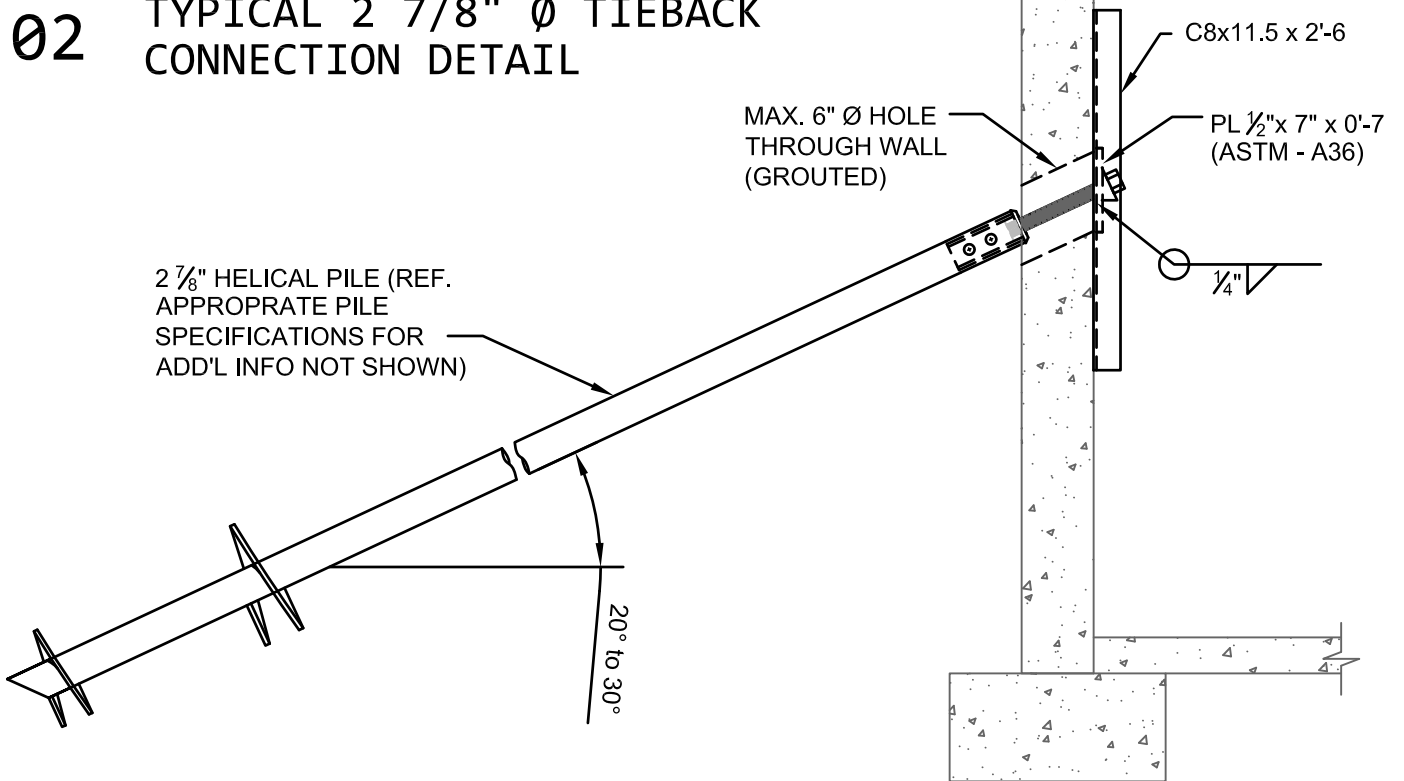

RECOGNIZED BY ICC-ES IN ESR-1854

Ø1 TYPICAL 2 7/8" Ø HELICAL TIEBACK ANCHOR DETAIL

ALLOWABLE TENSION

27.89 K (20° ANGLE)
27.59 K (30° ANGLE)



4550.2875 HELICAL TIEBACK

SHEET:

SK-1

SCALE:
3/4" = 1'-0

DATE:
8/28/2008