

TYPICAL LEAD SECTION

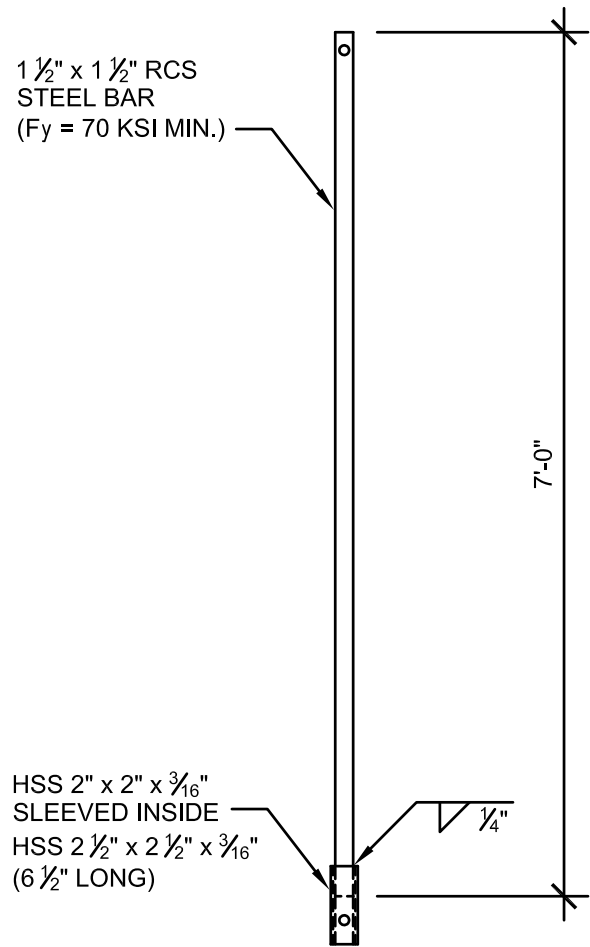

TYPICAL EXTENSION

**NOTES:**

1. USE 3/4"  $\varnothing$  SAE J429 GRADE 8 BOLTS FOR EXTENSION CONNECTIONS.
2. HELICAL LEAD SECTION AND EXTENSION TO BE THERMOPLASTIC POWDER COATED.
3. MAXIMUM TORQUE RATING IS 5,500 FT-LBS.

**01 TYPICAL 1 1/2" SQUARE BAR HELICAL ANCHOR DETAIL**

	1 1/2" SQUARE BAR SPEC	SHEET: <b>SK-2</b>
	SCALE: 3/4" = 1'-0"	DATE: 5/27/2009